



## Windows: Change Current Account Outlook 2010 (POP) \*\*\*\*\*Recommended for keeping a copy locally\*\*\*\*\*

This article will assist you with setting up Outlook 2010, using POP, for your Hosted Mailbox.

- Open your email account. By going to: File – Account Setting - Select Account to edit and double click to open.
- Input the following information as shown in image below:
  - a.
    - i. **"Incoming mail server"**: (We recommend [secure.emailsrvr.com](http://secure.emailsrvr.com))

Server	SSL	Port
<a href="http://secure.emailsrvr.com">secure.emailsrvr.com</a>	Yes	995
<a href="http://pop.emailsrvr.com">pop.emailsrvr.com</a>	No	110

- ii. **"Outgoing mail server (SMTP)"**: (We recommend [secure.emailsrvr.com](http://secure.emailsrvr.com))

Server	SSL	Port
<a href="http://secure.emailsrvr.com">secure.emailsrvr.com</a>	Yes	465
<a href="http://smtp.emailsrvr.com">smtp.emailsrvr.com</a>	No	587

- **"Logon Information"**:
  - i. **"Password"**: Re-enter your mailbox password If we changed it .

**Internet E-mail Settings**  
Each of these settings are required to get your e-mail account working.

**User Information**  
Your Name: Tom Jones  
E-mail Address: test@test.com

**Server Information**  
Account Type: POP3  
Incoming mail server: secure.emailsrvr.com  
Outgoing mail server (SMTP): secure.emailsrvr.com

**Logon Information**  
User Name: test@test.com  
Password: \*\*\*\*\*  
 Remember password  
 Require logon using Secure Password Authentication (SPA)

**Test Account Settings**  
After filling in the information above, click the Test Account Settings button to test the account settings.  
 Test Account Settings by clicking the Next button

**Deliver new messages to:**  
 New Outlook Data File  
 Existing Outlook Data File

Buttons: < Back, Next >, Cancel, More Settings ...

**Annotations:**  
- A grey oval with text "Type in the following email servers as shown" has red arrows pointing to the Incoming and Outgoing mail server fields.  
- A black oval with text "Enter new password from email we sent you" has a red arrow pointing to the Password field.  
- A red arrow points to the "More Settings ..." button.

- Now click on MORE SETTINGS: Click on the "Advanced" Tab
  - a. Change "Use the following type of encrypted connection" to "SSL".
  - b. Uncheck the Leave a copy of messages on the server check box.
  - c. Change the port numbers to match the image below. Click "OK".

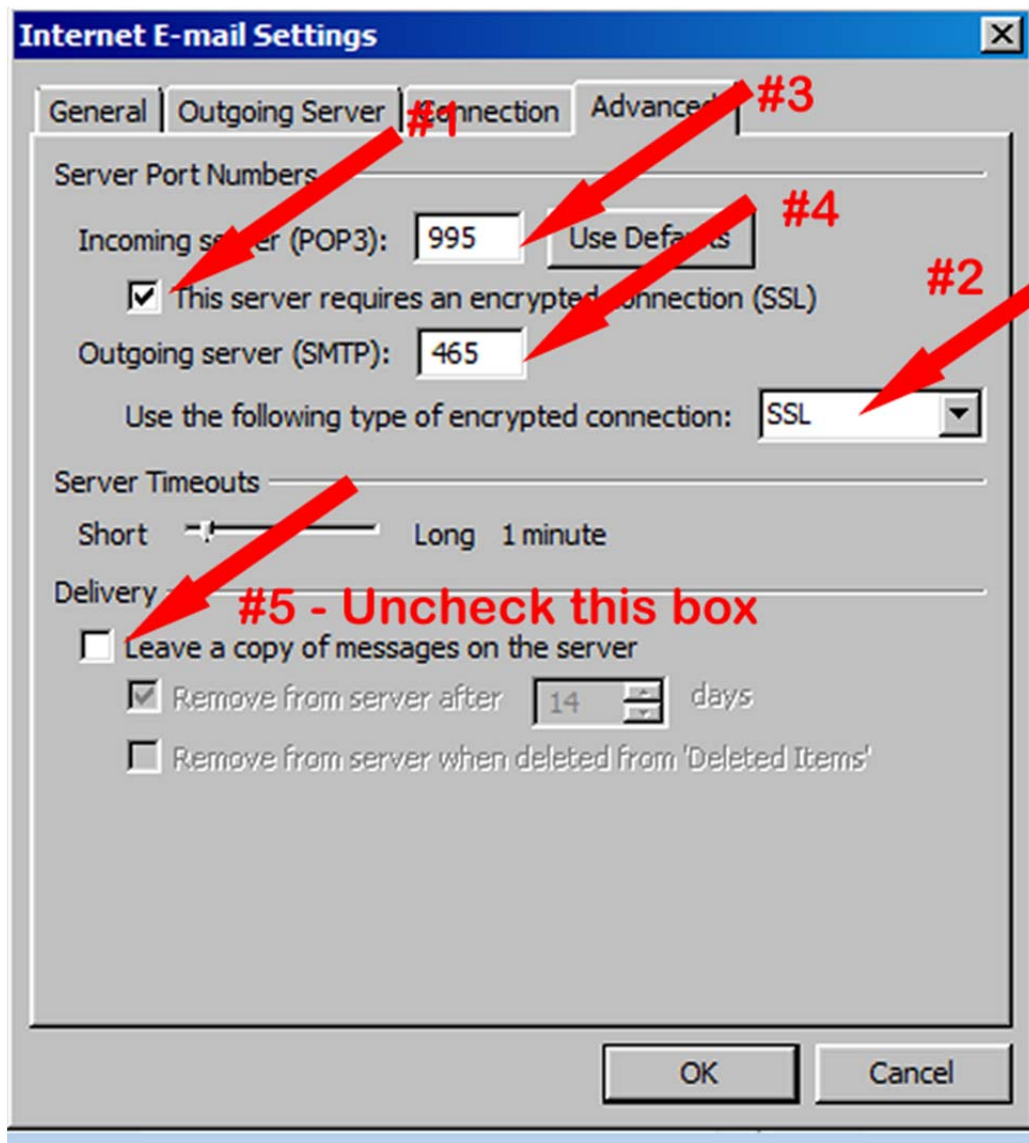

- Click "**Next**". Outlook will now attempt to send a test message using the settings we have just put in. If everything was entered correctly, the message will send out successfully.
- **If it get a connection error means your 995 and 464 ports are not open use option #2 below:**

## Option #2

### Internet E-mail Settings

Each of these settings are required to get your e-mail account working.



**User Information**

Your Name:

E-mail Address:

**Server Information**

Account Type:

Incoming mail server:

Outgoing mail server (SMTP):

**Logon Information**

User Name:

Password:

Remember password

Require logon using Secure Password Authentication (SPA)

**Test Account Settings**

After filling in the information above, click the Test Account Settings button to test the account.

Test Account Settings by clicking the Next button

**Deliver new messages to:**

New Outlook Data File

Existing Outlook Data File

**Type in the following email servers as shown**

**Enter new password from email we sent you**

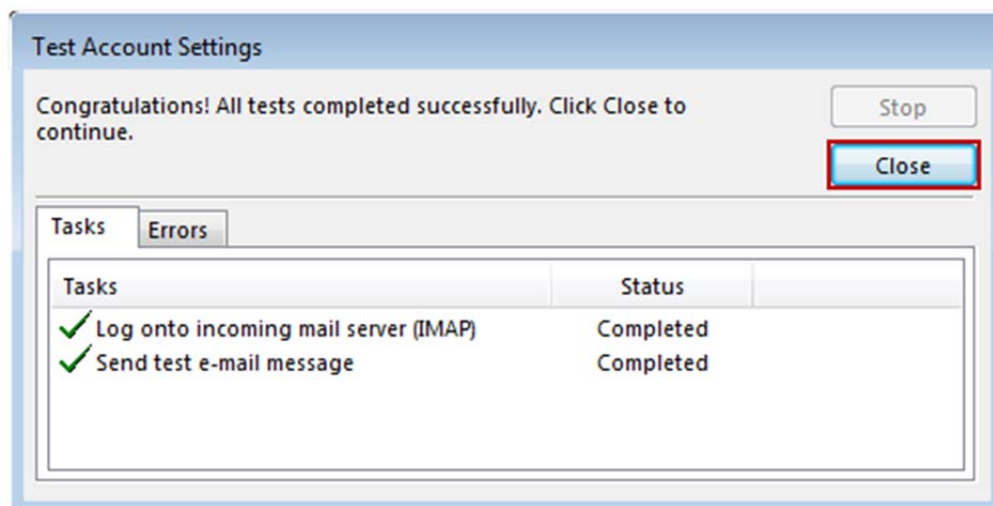
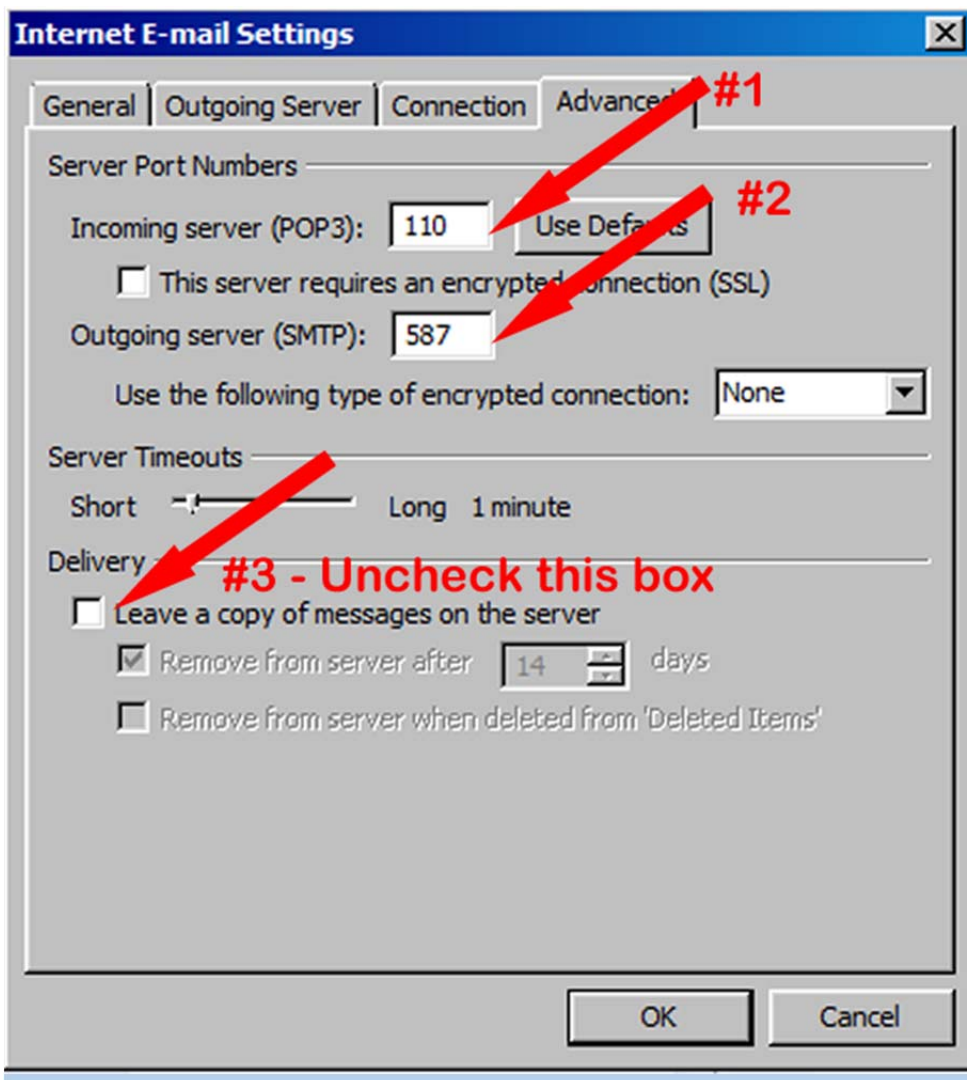

- **Congratulations!** You have now setup Outlook to work with your Mailbox!